

20  
23

JEROME &  
 ROHWER  
PILGRIMAGE



# WELCOME

Thank you all for joining us on the 2023 Jerome/Rohwer Pilgrimage! We are so excited to see the number of family groups and survivors attending this year. I truly believe that there is power not only in place, but also in community. Pilgrimages are a step toward reuniting the Nikkei Community that the war and our government tore apart.

I hope these four days are filled with learning, connection, and healing.

Kimiko Marr

I would like to dedicate this pilgrimage to my friend, Frank Inami, who passed away in 2017, just a month shy of his 96th birthday. Frank and his family were incarcerated at both Jerome and Rohwer and it was with Frank that I first visited the two sites.

I would also like to dedicate this pilgrimage to Atsuko Shimasaki Kusuda and Fred Shimasaki who attended my first pilgrimage with their siblings Rinko and Joe. Atsuko passed away in 2020 at the age of 97 and Fred passed away in 2021 at the age of 96.



Frank Inami



Atsuko Shimasaki Kusuda



Fred Shimasaki

# PILGRIMAGE GIFT ARTISTS



## Mits Yamamoto

Mits Yamamoto was born in 1926 in Sacramento. He and his family were sent to Jerome, AR and then Gila River.



## Gracie Mitsuye Farley

Grace is the yonsei granddaughter of Jerome and Rohwer survivor Kazuko Yamamoto. She is extremely grateful for the time she got to spend with her grandmother and hear about her life before, during, and after the camps.



### About the Art

The bird on the enamel pin is the Northern Mockingbird, the state bird of Arkansas, and is based off of wooden bird pins created by internees. The rubber stamps depict scenes from historical photos of the respective camps.

## Jerome Stamp

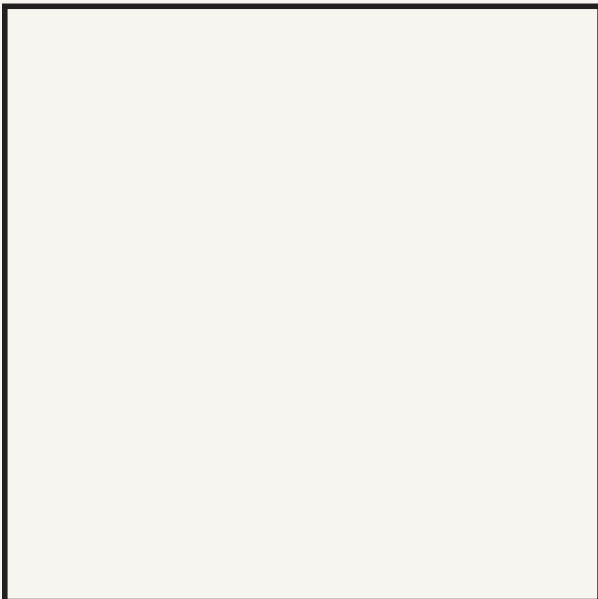

## Rohwer Stamp

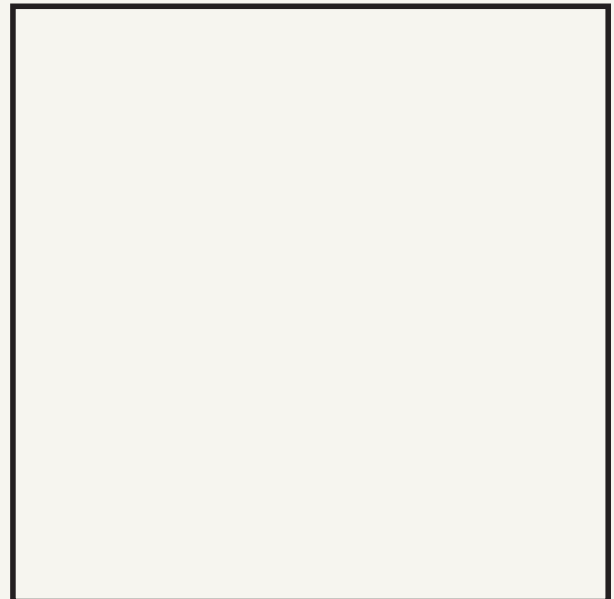

### Stamp Meaning

The pilgrimage stamps are intended to be used in a pilgrimage book which is a cross between Japanese pilgrimage books and the National Parks Service passport book. Many of the other camp pilgrimages have had their own designs created.



# PILGRIMAGE LOCATIONS

## Pilgrimage Locations-Little Rock

1

Comfort Inn & Suites  
Presidential

2

Holiday Inn Little Rock-  
Presidential-Dwntn, an IHG  
Hotel

3

Ron Robinson Theater --  
Central Arkansas Library  
System

4

Roberts Library - Central  
Arkansas Library System

5

Albert Pike Memorial Temple

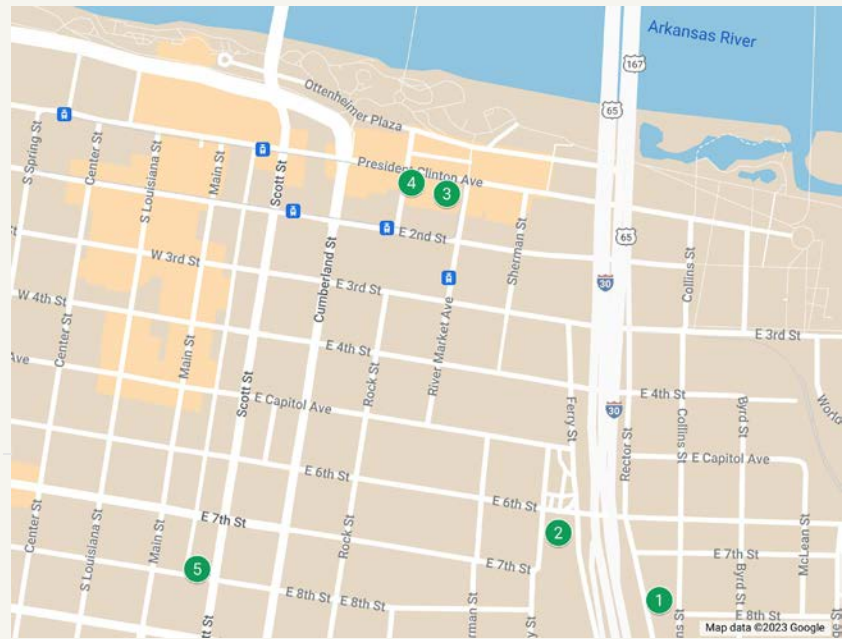

## Pilgrimage Locations-McGehee

1

Rohwer Heritage Site

2

World War II Japanese  
American Internment Museum

3

Jerome Relocation Center  
Memorial

4

McGehee Men's Club  
Community Center

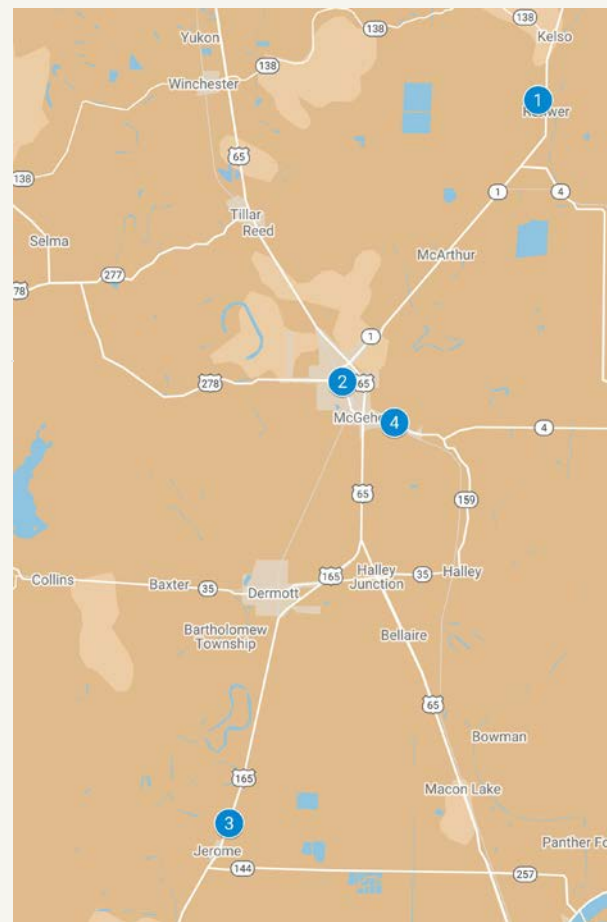



# COMFORT INN MAP

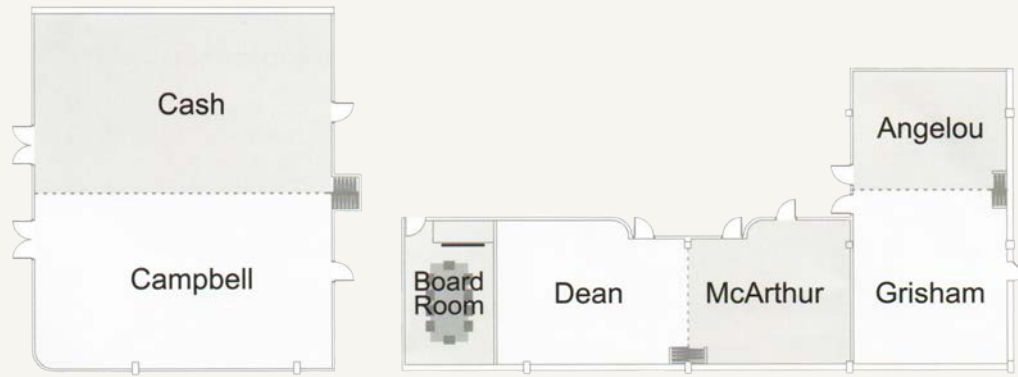

# HOLIDAY INN MAP

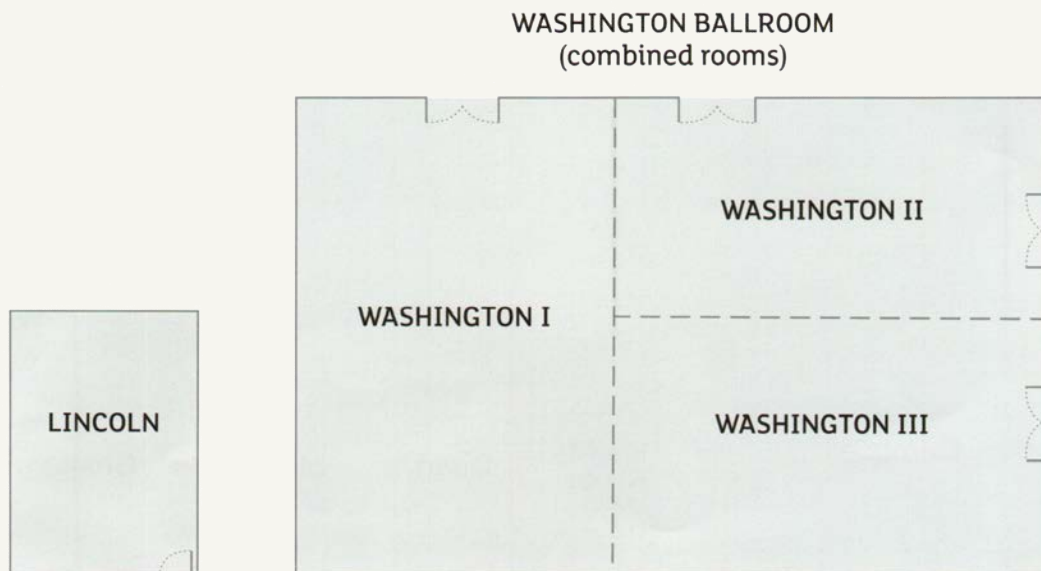



# SCHEDULE OVERVIEW

<b>3</b> WED	<b>4</b> THU	<b>5</b> FRI	<b>6</b> SAT
<p><b>Welcome Packets Pick Up</b> Comfort Inn-Cash Campbell Ballroom Beginning at 4pm</p> <p><b>Welcome Dinner</b> <i>Duncan Williams</i> Comfort Inn-Cash Campbell Ballroom 6pm-8pm</p> <p><b>After Hours Social</b> (optional) Comfort Inn-Cash Campbell Ballroom Holiday Inn-Lincoln Room 8pm-10pm</p>	<p><b>Travel to McGehee</b> <i>Be on buses by 7:30am</i> 8am-10:30am</p> <p><b>Visit Rohwer Cemetery</b> 10:30am-11:45am</p> <p><b>Anniversary Program at Museum</b> 1pm-2pm</p> <p><b>View Jerome Memorial</b> 3:30pm-4pm</p> <p><b>BBQ Dinner</b> McGehee Men's Club 5pm-7pm</p> <p><b>Return to Little Rock</b> 7pm-9:30pm</p>	<p><b>Arkansas: Histories of Place</b> Ron Robinson Theatre 10am-11:15am</p> <p><b>Rising Above Arkansas</b> Ron Robinson Theatre 11:30am-12:30pm</p> <p><b>Lunch on Your Own</b> 12:30pm-1:45pm</p> <p><b>Japanese Americans in the South</b> Ron Robinson Theatre 1:45pm-3pm</p> <p><b>Jerome and Rohwer Survivor Panel</b> Ron Robinson Theatre 3:15pm-5pm</p> <p><b>Dinner on Your Own</b> 5pm</p> <p><b>After Hours Social Ireizo Recordings</b> 8pm-10pm</p>	<p><b>Authors Panel</b> Followed by book signing 9am-10:30am</p> <p><b>Refusing to Answer the Loyalty Questionnaire</b> Comfort Inn-Cash Campbell Ballroom 11am-12pm</p> <p><b>Lunch on Your Own</b> 12pm-2:30pm</p> <p><b>Intergenerational Discussion Groups</b> Comfort Inn/Holiday Inn Conference Rooms 3pm-5pm</p> <p><b>Farewell Dinner</b> Albert Pike Temple 6pm-8pm</p> <p><b>After Hours Social</b> Comfort Inn-Ballroom Holiday Inn-Lincoln</p> <p><b>Ireizo Recordings</b> Comfort Inn-Boardroom 8pm-10pm</p>



# DAY 1 & 2 PROGRAMMING

## WEDNESDAY, MAY 3

**Cash/Campbell Ballroom** Comfort Inn & Suites Presidential 707 Interstate 30 Little Rock, AR

4pm	<b>WELCOME PACKETS AVAILABLE FOR PICK UP</b>
6pm - 6:15pm	<b>WELCOME</b>
6:15pm - 7pm	<b>DINNER</b>
7pm - 8pm	<b>DUNCAN WILLIAMS</b> <p>Duncan Ryūken Williams will talk about the Ireichō book that contains the first comprehensive listing of the over 125,000 names of persons of Japanese ancestry who were incarcerated in US Army, Department of Justice, Wartime Civil Control Administration, and War Relocation Authority camps. He will also share with us his plans for phase two of his project, the Ireizō website, which lists the names from the Ireichō and is searchable by a person's name, birth year, or camp.</p>

## THURSDAY, MAY 4

Buses will pick up in front of the Comfort Inn & Suites Presidential and the Holiday Inn Presidential.  
**Please be on your bus by 7:30am.**

8am - 10:30am	<b>TRAVEL TO MCGEHEE</b>
10:30am - 11:45am	<b>VISIT ROHWER CEMETERY</b>
11:45am - 12pm	<b>TRAVEL TO WWII JAPANESE AMERICAN INTERNMENT MUSEUM</b> 100 South Railroad Street McGehee, AR 71654
12pm - 1pm	<b>LUNCH ON YOUR OWN</b>
1pm - 2pm	<b>MUSEUM 10TH ANNIVERSARY PROGRAM</b>
2pm - 3pm	<b>CONTINUE VISITING MUSEUM</b>
3pm - 3:30pm	<b>TRAVEL TO JEROME</b>
3:30pm - 4pm	<b>VIEW JEROME MEMORIAL</b>
4pm - 4:30pm	<b>TRAVEL TO MCGEHEE CLUB FOR BBQ</b> 1 S Airport Rd, McGehee, AR 71654
5pm - 7pm	<b>BBQ DINNER</b>
7pm - 9:30pm	<b>RETURN TO LITTLE ROCK</b>



# DAY 3 PROGRAMMING

**FRIDAY, MAY 5**

**Ron Robinson Theater** Liberty Square, 100 River Market Ave, Little Rock, AR 72201

9:30am

## **DOORS OPEN**

10am - 10:05am

## **WELCOME REMARKS**

10:05am - 11:15am

## **ARKANSAS: HISTORIES OF PLACE**

This panel, which kicks off our day of programming in Little Rock, is centered around broader histories of place. What stories have shaped Arkansas and the U.S. South into the place that we are visiting today? How did these histories impact what it means for our community to be here in Arkansas on pilgrimage?

While we will be talking and learning a lot about Japanese American histories in Arkansas and elsewhere in the South over the course of the day, we want to begin by making time to learn about the other communities and histories that have shaped—and continue to shape—Arkansas and the South today. Of course, this panel will only brush the surface, but we hope it will help provide a better sense of where we are.

Most broadly, this panel will touch on Native histories (and ongoing presence) in Arkansas and the South, histories of labor and race, stories about women, and stories of the Civil Rights Movement. Like Japanese American incarceration histories, each of these topics have clear and important implications for the present. We look forward to a rich conversation during the Q&A and to carrying these stories and our questions throughout the pilgrimage.

Moderator: Erin Aoyama

Panelists: Dr. Cherisse Jones-Branch, Richard Yada and Dr. Brian Mitchell, Brian Schwieger and Robin White

11:30am - 12:30pm

## **RISING ABOVE ARKANSAS: ADDING NEW MATERIALS FOR THE JEROME CAMP**

The Rising Above in Arkansas project and website is dedicated to preserving the history of the two Arkansas camps at Rohwer and Jerome. With support from the Japanese American Confinement Sites program in the National Park Service, the project has been ongoing for nearly a decade with contributions from numerous Arkansas institutions including the University of Arkansas, Arkansas State Archives, the Butler Center for Arkansas Studies, Arkansas State University, the University of Arkansas Little Rock – Center for Arkansas History and Culture, and the WWII Japanese American Internment Museum in McGehee. The project website ([risingabove.cast.uark.edu](http://risingabove.cast.uark.edu)) uses an engaging and technological framework to tell the story of Japanese American incarceration in Arkansas interweaving 3D technologies, interactive maps, and primary source materials with searchable metadata. Panel participants will discuss the most recent updates to the site which include adding over 1,100 items to the project archive and expanding the maps and timeline to include new materials related to Jerome. With the project now complete, the Rising Above in Arkansas website is one of the premier online resources for learning about the unique history of the two Arkansas camps.

Presenters: Kimball Erdman, Angelia Payne, Joshua Youngblood, and Bridget Wood





# DAY 3 CONT.

## FRIDAY, MAY 5

**Ron Robinson Theater** Liberty Square, 100 River Market Ave, Little Rock, AR 72201

12:30pm - 1:45pm

### LUNCH ON YOUR OWN

1:45pm - 3pm

### JAPANESE AMERICANS IN THE SOUTH

*Nisei and Nisei Soldiers During and After World War II - Okage Sama De.....We (sansei) are products of the "Greatest Generation".....Let's continue their legacy.*

Presenter: L. Stuart Hirai

*Exploring Louisiana's Internment History: Camp Livingston and WWII Internment - Learn about the history of Camp Livingston, an Army camp in central Louisiana, that served as a site of internment of over 1000 Japanese American men during WWII.*

Presenters: Hayley Johnson, Sarah Simms

3:15pm - 5pm

### SURVIVOR PANEL

We are lucky enough to have several survivors of the Jerome and Rohwer camps who will be sharing their memories of camp. Don't miss this opportunity to ask questions of people who actually lived through the incarceration and its aftermath.

Moderator: Kimiko Marr

5pm

### DINNER ON YOUR OWN

8pm - 10pm

### OPTIONAL AFTER HOURS SOCIAL





# DAY 4 PROGRAMMING

## SATURDAY, MAY 6

Comfort Inn & Suites Presidential 707 Interstate 30 Little Rock, AR 72202

9am - 10:30am

### AUTHORS PANEL: INSPIRED BY ARKANSAS

*Followed by book signing*

Join us as the authors of four novels, each inspired by Arkansas, discuss their writings: *Of White Ashes*, *Block Seventeen*, *A Good Country*, and *Two Nails, One Love*.

Moderator: Kent Matsumoto      Panelists: Constance Matsumoto, Kimiko Guthrie, Sofia Ali-Khan, Alden Hayashi

11am - 12pm

### "REFUSING TO ANSWER" THE LOYALTY QUESTIONNAIRE AT JEROME

Nancy Ukai, director of the 50 Objects project, and James Okumura, a Jerome and Tule Lake descendant, will discuss loyalty questionnaires from Jerome in which inmates wrote "refuse to answer" as a coordinated act of resistance. James will discuss the background of his family's responses and the consequences of their decisions.

Presenters: Nancy Ukai, James Okumura

12pm - 2:30pm

### LUNCH ON YOUR OWN

3pm - 5pm

### INTERGENERATIONAL DISCUSSION GROUPS

SEE BELOW

6pm - 8pm

### FAREWELL DINNER

*Albert Pike Memorial Temple*

8pm - 10pm

### OPTIONAL AFTER HOURS SOCIAL

#### DISCUSSION GROUPS LOCATIONS

##### *Comfort Inn & Suites Presidential*

- 01 Cash
- 02 Campbell
- 03 Angelou
- 04 Grisham
- 05 McArthur
- 06 Dean

##### *Holiday Inn Presidential*

- 07 Lincoln
- 08 Washington I
- 09 Washington II
- 10 Washington III

reference maps on page 6



# SPEAKERS



## **SOPHIA ALI-KHAN**

Ali-Khan is a social justice lawyer turned writer/storyteller. Her writing at the intersection of politics, race, history, and Muslim America has appeared in the Los Angeles Times, TIME Magazine, the Chicago Tribune, among other publications. As a lawyer, she became a national leader on the right to language access, creating the policies, protocols, and trainings for language access across an eleven office legal services agency.



## **KIMBALL ERDMAN**

Kimball Erdman is a Professor of Landscape Architecture in the Fay Jones School of Architecture and Design at the University of Arkansas. Erdman and his students have conducted projects for the Japanese American incarceration camps at Rohwer and Jerome, Arkansas; Buffalo National River, Arkansas; Pea Ridge National Military Park, Arkansas; Cane River Creole National Historical Park, Louisiana; and many others historically significant sites since 2009, following a decade of similar work in the private sector.



## **KIMIKO GUTHRIE**

Kimiko Guthrie is the cofounder of Dandelion Dance theater and a lecturer at Cal State East Bay. She holds an MFA in choreography from Mills College. Her work has been presented internationally and has received numerous grants and awards. Block Seventeen, which was inspired by her experience growing up with a mother who was incarcerated in a Japanese American internment camp, is her first book.



## **ALDEN HAYASHI**

Hayashi has been a writer/editor at various publications, including Scientific American, The Harvard Business Review, and MIT Sloan Management Review. Recently, he's become increasingly restless in his work, wanting to move beyond covering just science, technology, and business. As a Sansei, he now wants to write about his family as a way to honor the memories of his grandparents' immigration to Hawaii, as well as to preserve the stories of the lives of their many descendants.



## **L. STUART HIRAI**

Hirai is a Sansei, raised on an irrigated farm/ranch in eastern Oregon whose Nisei mentors served in the MIS/100th IB/442nd RCT. He has toured and led "small group tours" to the battle sites the 100th IB/442nd RCT and spoken at various WWII seminars. He is actively researching/writing a book about his Nisei mentors, the military (100th/442nd/MIS), "stranded in Japan," and resisters after the bombing of Pearl Harbor.



## **HAYLEY JOHNSON**

Hayley Johnson is the Head of Open Scholarship and Government Publications at the Louisiana State University Library. She has been researching the Japanese who were interned in Louisiana during WWII, and with the help of three Carnegie Whitney grants from the American Library Association, it has since expanded to include an exploration of stories from communities that have been historically omitted from narratives about the settlement of the American West.



## **DR. CHERISSE JONES-BRANCH**

Dr. Jones-Branch is Dean of the Graduate School and Professor of History at Arkansas State University where she has been employed since 2003. She received her B.A. and M.A. from the College of Charleston, and a Ph.D. from The Ohio State University. A Rural, Women's and African American history scholar, Dr. Jones-Branch is the author of Crossing the Line: Women and Interracial Activism in South Carolina during and after World War II, in addition to many articles and essays.



# SPEAKERS



## CONSTANCE & KENT MATSUMOTO

Connie writes stories and poetry intended to influence positive change in our world. She earned her B.A. from Notre Dame of Maryland University and M.S. in Business from Johns Hopkins University. Kent, a third-generation Japanese American, spent his formative years living in Japan where he attended the American School. He earned his degrees from the University of Virginia and University of Michigan Law School, and has worked in law firms and private and public companies.



## DR. BRIAN MITCHELL

Dr. Brian Mitchell spent more than 16 years as a professor of history at University of Arkansas–Little Rock, now serves as the Director of Research and Interpretation at the Abraham Lincoln Presidential Library and Museum in Springfield, Illinois.



## JAMES OKAMURA

Born in Boyle Heights, Sansei and native Angeleno, James Okumura grew up in the West San Gabriel Valley foothill communities of Altadena and Pasadena. He graduated from John Muir High School, UCLA, and USC. After working in Information Systems for nearly thirty years, James retired to pursue his lifelong interests in ceramics, family history, and gardening. His maternal roots lie in the hills overlooking the Yokohama area of Kanagawa-ken. His paternal ancestry originates along the bays and shores of Ise-Shima in Mie-ken.



## ANGELIA PAYNE

Angelia Payne is a Senior Research Assistant at the Center for Advanced Spatial Technologies (CAST) at the University of Arkansas. She is a technical specialist with an emphasis in geospatial technologies, reality capture, digital modeling and 3D visualization of landscapes. With a background in archaeology and history, she enjoys using technology to enliven the stories of the past and to engage new audiences.



## BRIAN SCHWIEGER

Brian Schwieger serves as the Supervisory Park Ranger for Interpretation at Little Rock Central High School National Historic Site. A native of Nashville, Tennessee, Brian holds a B.A. in Social Science from Harding University, an M.A. in History from the University of Arkansas and a Masters Certificate from Stephen F. Austin State University. Over his twelve-year federal career, he has also served at two additional units of the National Park Service - Guadalupe Mountains National Park in Texas and Hot Springs National Park in Arkansas.



## SARAH SIMMS

Sarah Simms is the Undergraduate & Student Success Librarian at Louisiana State University. She has been researching the Japanese who were interned in Louisiana during WWII. Their work began in 2016 with research that examined the internment of Japanese and Japanese Americans in Louisiana during World War II, and with the help of three Carnegie Whitney grants from the American Library Association, it has since expanded to include an exploration of stories from communities that have been historically omitted from narratives about the settlement of the American West.



## NANCY UKAI

Nancy Ukai is project director of the website, "50 Objects/Stories of the American Japanese Incarceration," a National Park Service JACS grant project. She helped lead a social media protest against the Rago auction of the Eaton collection of camp artifacts in 2015 and researched their provenance as an advisor to the Japanese American National Museum. She is a founding member of the Wakasa Memorial Committee, chair of the Nichi Bei Foundation board and co-founder of Tsuru for Solidarity.

# SPEAKERS



## DUNCAN RYUKEN WILLIAMS

Williams is Professor of American Studies & Ethnicity and Religion and the Director of the Shinso Ito Center for Japanese Religions and Culture at the University of Southern California. He was the founding Executive Vice President of JAPAN HOUSE/LA, and serves on the boards of organizations ranging from the Japan Foundation, the Harvard Pluralism Project, and Tricycle Magazine. His most recent project is the building of the Irei Names Monument, a memorial to honor those of Japanese ancestry who were incarcerated in America's internment and concentration camps during WWII.



## ROBIN WHITE

Robin White is the Superintendent of Little Rock Central High School National Historic Site; throughout her career at divergent parks, she has developed a reputation of generating a ground swell of support through community driven programs and sustainable partnerships. Robin has cultivated partnerships connecting the National Park Service with Derry, Ireland and indigenous Australians. She holds a Bachelor's degree in Criminal Justice and a master's degree in Public Policy, Social Issues and Leadership.



## BRIDGET WOOD

Bridget Wood is the Archival Manager of Technology and Access at the Arkansas State Archives, where she's worked for nearly 6 years. Prior to this, Wood was a graduate assistant at the University of Arkansas at Little Rock's Center for Arkansas History and Culture (CAHC). Wood has an M.A. in Public History and holds certificates of Arrangement and Description (A&D) and Digital Archives Specialist (DAS) from the Society of American Archivists.



## RICHARD YADA

Richard Yada was born August 18, 1943 in the Rohwer, Arkansas Camp. When the camp was closed in November, 1943, Richard's family stayed in Arkansas and worked as sharecrop vegetable farmers just outside of Little Rock. He attended the University of Arkansas, Fayetteville, and graduated in 1965 with a BSBA and a major in Accounting. Yada later entered the Air Force and flew 59 combat missions and completed his tour of duty with an honorable discharge with the rank of Captain.



## JOSHUA YOUNGBLOOD

Joshua Youngblood is the Instruction and Outreach Unit Head for the Special Collections Division in the University of Arkansas Libraries, where he also serves as the history and rare books librarian and the curator of the Arkansas Collection. He has published on digital archival exhibiting and archival instruction programs, as well as on the history of Arkansas, lynching, and reform movements in the American South. A graduate of Florida State University, Youngblood is a certified archivist and a past president of the Society of Southwest Archivists.



# PLANNING COMMITTEE

KIMIKO MARR

NICOLE TANNER

ERIN AOYAMA

NATALIE KIMURA

CAROLINE KIMURA

ALLYN SUZUKI

MONIKA MIZOTA

# SPECIAL THANKS

**MAYOR JEFF OWYOUNG**

**ROBIN WHITE**

**HEATHER ZBINDEN**

**BRIAN SCHWIEGER**

**DAVE & PAULA POPE**

This project was funded, in part, by a grant from the U.S. Department of the Interior, National Park Service, Japanese American Confinement Sites Grant Program. The views and conclusions contained in this document are those of the authors and should not be interpreted as representing the opinions or policies of the U.S. Government. Mention of trade names or commercial products does not constitute their endorsement by the U.S. Government.

This material received Federal financial assistance for the preservation and interpretation of U.S. confinement sites where Japanese Americans were detained during World War II. Under Title VI of the Civil Rights Act of 1964, Section 504 of the Rehabilitation Act of 1973, and the Age Discrimination Act of 1975, as amended, the U.S. Department of the Interior prohibits discrimination on the basis of race, color, national origin, disability or age in its federally funded assisted projects. If you believe you have been discriminated against in any program, activity, or facility as described above, or if you desire further information, please write to:



Office of Equal Opportunity  
National Park Service  
1201 Eye Street, NW (2740)  
Washington, DC 20005

The HEART MOUNTAIN WYOMING FOUNDATION is proud to support the 2023 JEROME/ROHWER PILGRIMAGE!



HEART MOUNTAIN WYOMING FOUNDATION

[www.heartmountain.org](http://www.heartmountain.org)  
[info@heartmountain.org](mailto:info@heartmountain.org)  
307.754.8000  
1539 Road 19  
Powell, WY 82435



SAVE THE DATE

**TADAIMA**

COMING OCTOBER 2023

# EMERGENCY CONTACT INFORMATION

Nicole Tanner

cell (217) 979-1222

## CLOSEST HOSPITALS IN LITTLE ROCK

**UAMS Health**  
4301 West Markham Street  
Little Rock, AR 72205  
(501) 686-7000

**Baptist Health Medical Center**  
9601 Baptist Health Dr  
Little Rock, AR 72205  
(501) 202-2000

## URGENT CARE IN LITTLE ROCK

**UAMS Neighborhood Clinic**  
1401 W. Capitol Ave.  
Little Rock, AR 72201  
(501) 320-7000

**Baptist Health Urgent Care**  
3550 Springhill Dr.  
North Little Rock, AR 72117  
(501) 374-2629

## CLOSEST HOSPITALS ON US 65 TO MCGEHEE

**Jefferson Regional Medical Center**  
1600 W. 40th Avenue  
Pine Bluff, AR 71603  
(870) 541-7100

**McGehee Hospital**  
900 S. 3rd Street  
McGehee, AR 71654

**Delta Memorial Hospital**  
811 US 65  
Dumas, AR 71639  
(870) 382-4303